

SIDE VIEW

***NOTE:**
FOR BLOCKS USED AS BASE COURSE,
REAR LUG NEEDS TO BE REMOVED

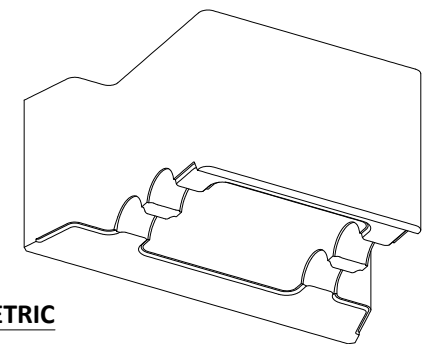
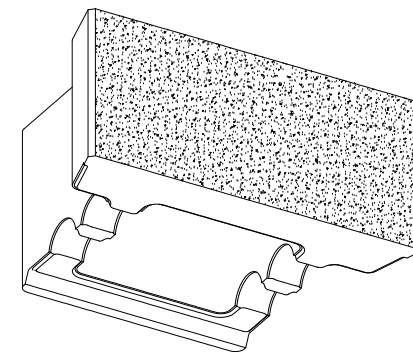
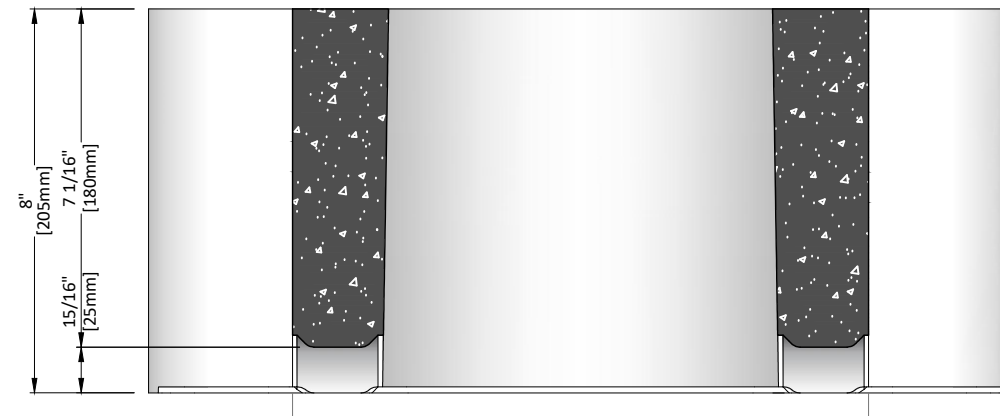
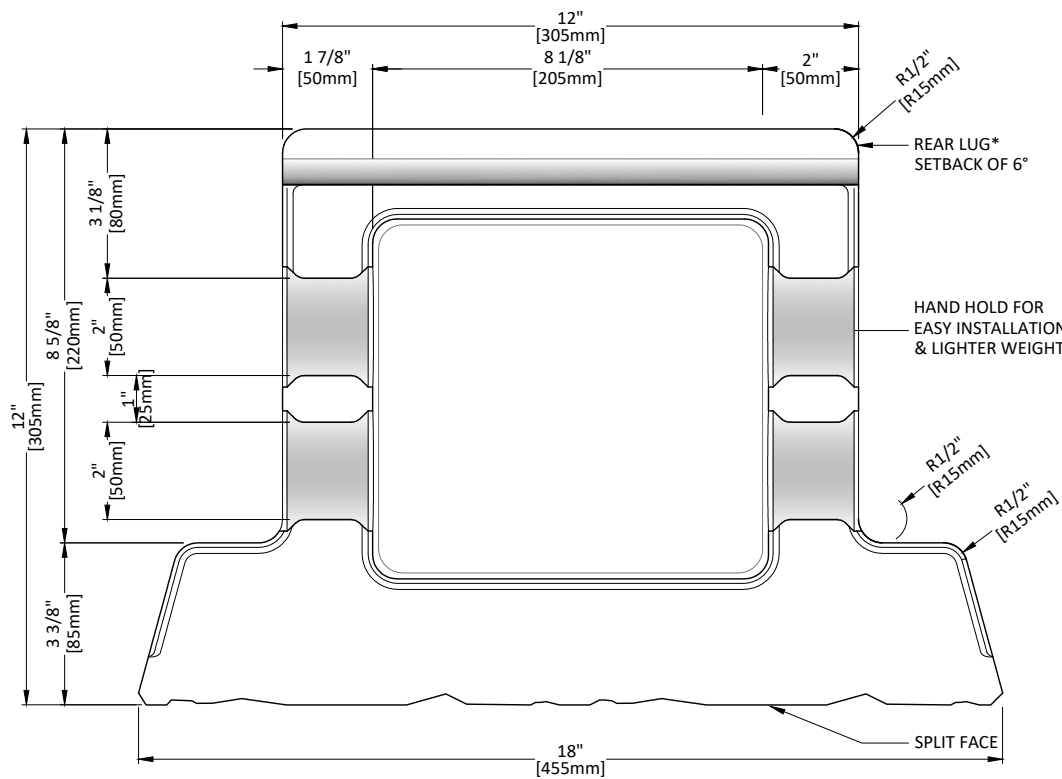
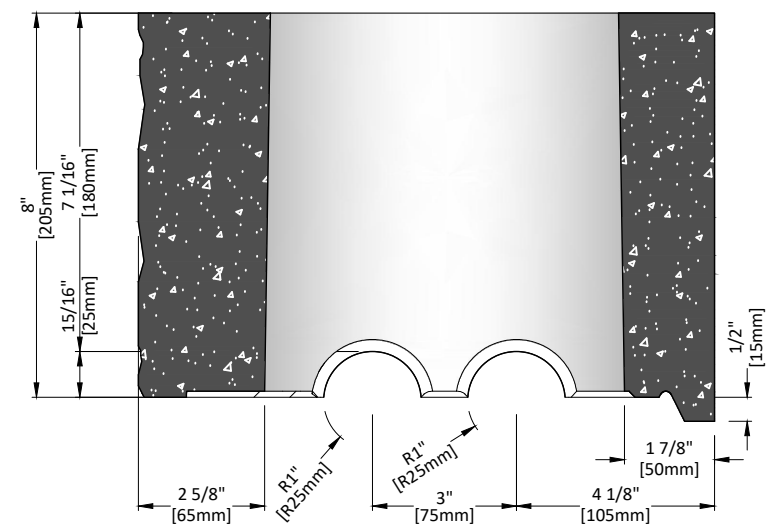

DESCRIPTION	IMPERIAL	METRIC
Face Width	18"	457.2 mm
Back Width	12"	304.8 mm
Depth (±)	12"	304.8 mm
Height	8"	203.2 mm
Face Area	1 ft²	0.092 m²
Weight (±)	60 lbs	0.45 kg
Setback	6°	

GENERAL NOTES:

These drawings are intended solely to act as an aid when designing a wall. This drawing should not be used for final design or construction.

Each site-specific wall should be certified and signed by a registered geotechnical engineer in the State or Province that it is being built.

The accuracy and use of the details in this document are the sole responsibility of the user.

01	BLOCK CUTOUT REVISED	07-26-2024
rev	DESCRIPTION	DATE

REMARKS:

PURPOSE OF ISSUE:

- ☐ INFORMATION
☐ REVIEW / APPROVAL
☐ PRODUCTION

SHEET CONTENT

FORTUS_12D BLOCK TECHNICAL DETAILS

SHEET REFERENCE

101

1401-F12-GEN

DRAWING INFORMATION

SCALE : 3" : 1-0'

PAPER SIZE: 17" WD X 11" HT

PREPARED BY: RM



WWW.CORNERSTONEWALLSOLUTIONS.COM
1 (800) 939-9193

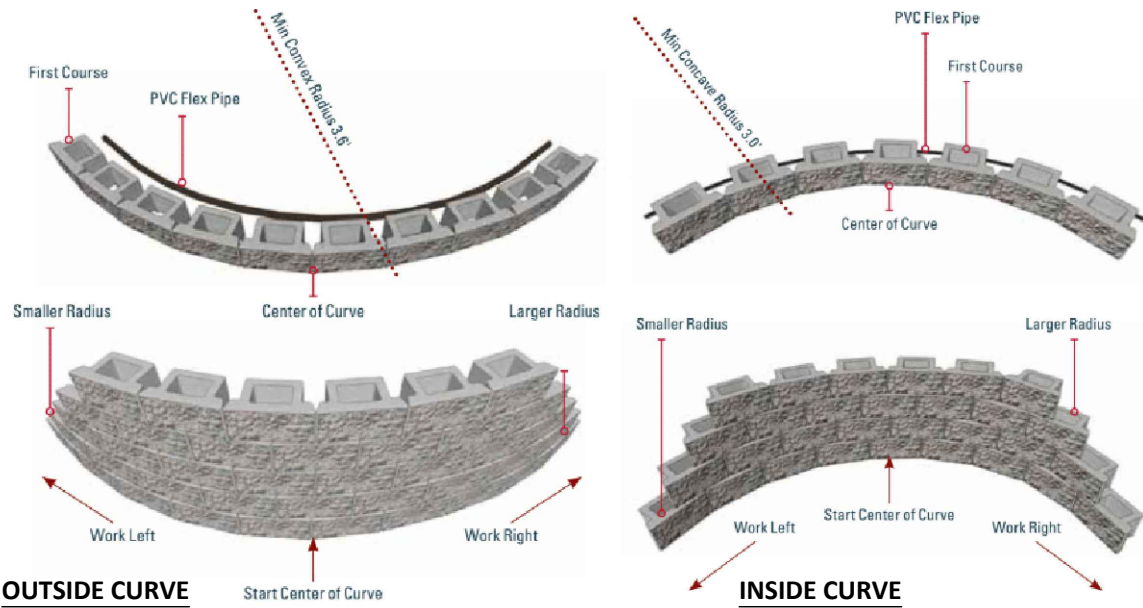

CURVES AND CORNERS
N.T.S.

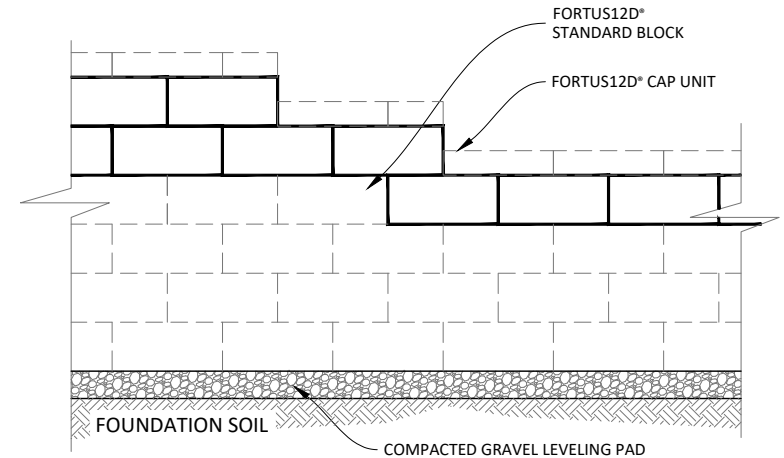

TOP OF WALL STEP UP/ DOWN

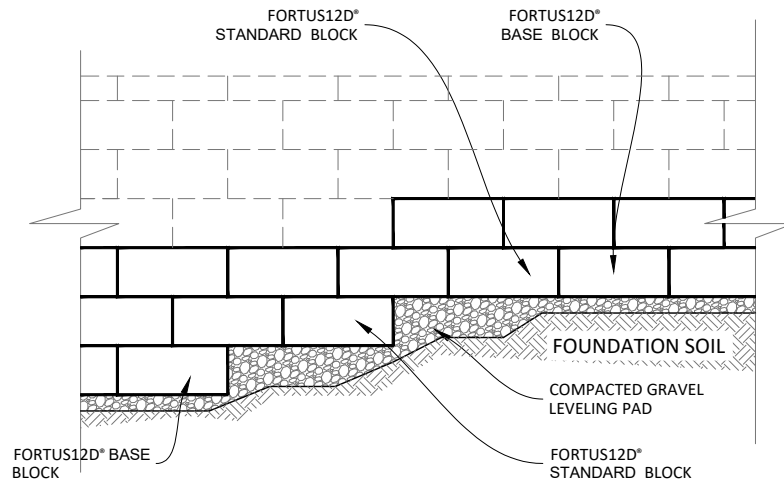

BASE OF WALL STEP UP/ DOWN

FRONT ELEVATION
N.T.S.

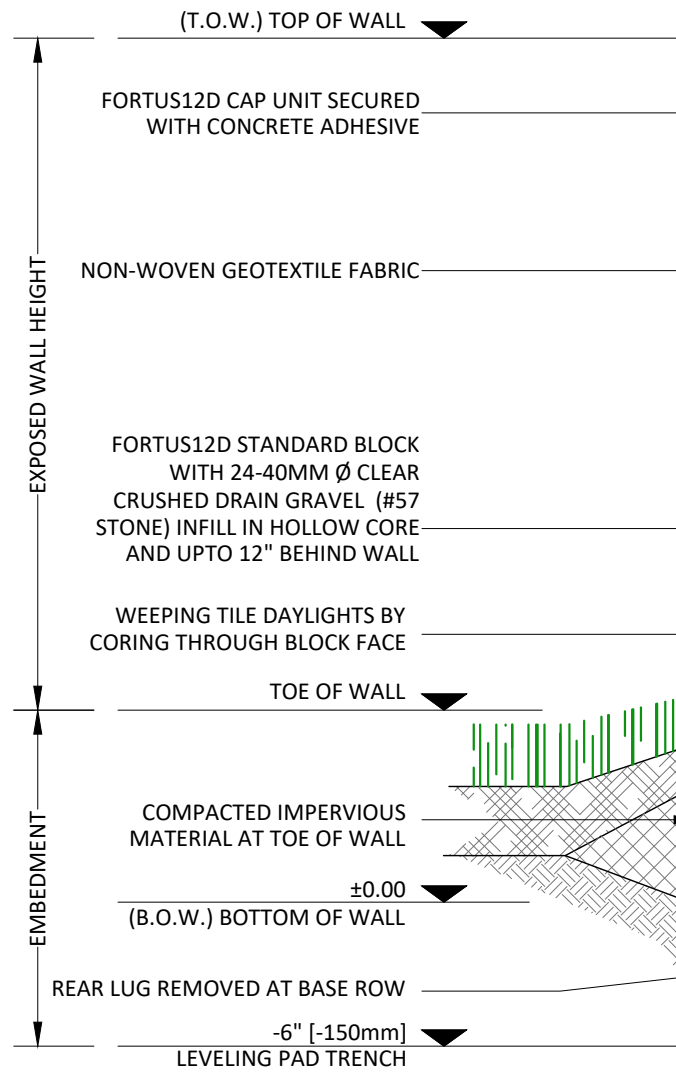

WALL CROSS SECTION
SCALE: 1 1/2" = 1'-00"

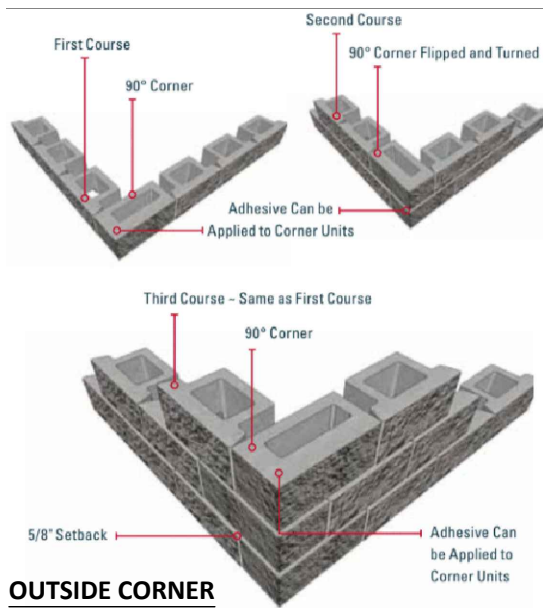

OUTSIDE CORNER

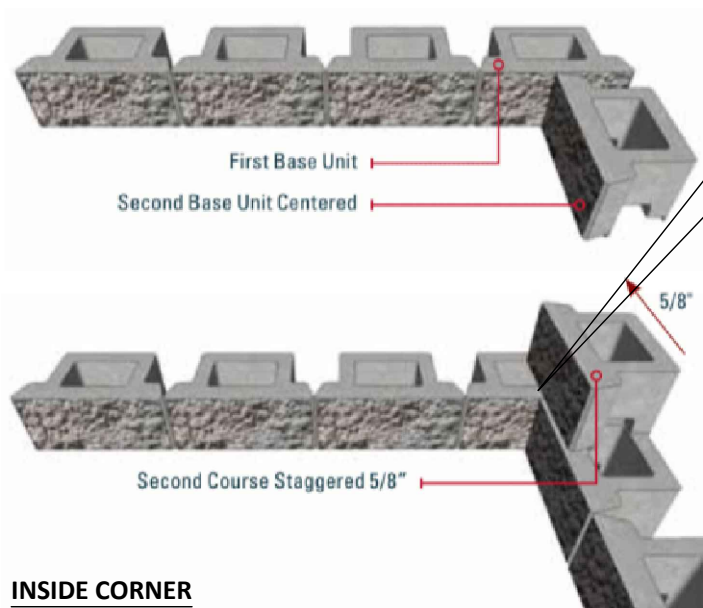

INSIDE CORNER

CORNER DETAIL

NOTE:

- PLACE SECOND UNIT AT RIGHT ANGLE AND CENTERED TO THE 1ST UNIT ON THE 2ND COURSE
- ENSURE SECOND COURSE UNITS ARE PLACED AT A 5/8" SETBACK TO THE LOWER INSIDE CORNER

GENERAL NOTES:

These drawings are intended solely to act as an aid when designing a wall. This drawing should not be used for final design or construction.

Each site-specific wall should be certified and signed by a registered geotechnical engineer in the State or Province that it is being built.

The accuracy and use of the details in this document are the sole responsibility of the user.

01	BLOCK CUTOUT REVISED	07-26-2024
Rev	DESCRIPTION	DATE

REMARKS:

PURPOSE OF ISSUE:

- ☐ INFORMATION
- ☐ REVIEW / APPROVAL
- ☐ PRODUCTION

SHEET CONTENT

GRAVITY WALL
CROSS SECTION

COMMON
APPLICATIONS

SHEET REFERENCE

201

1401-F12-GEN

DRAWING INFORMATION

SCALE : 3" : 1'-0"
PAPER SIZE: 17" WD X 11" HT
PREPARED BY: RM



WWW.CORNERSTONEWALLSOLUTIONS.COM
1 (800) 938-9193

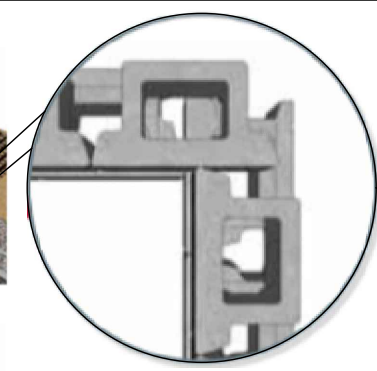
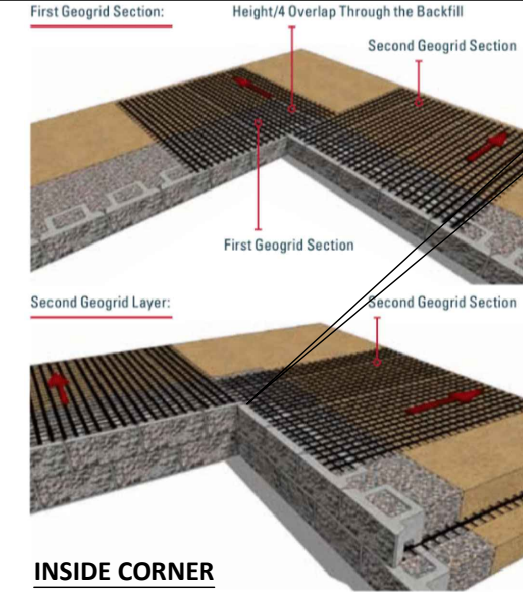
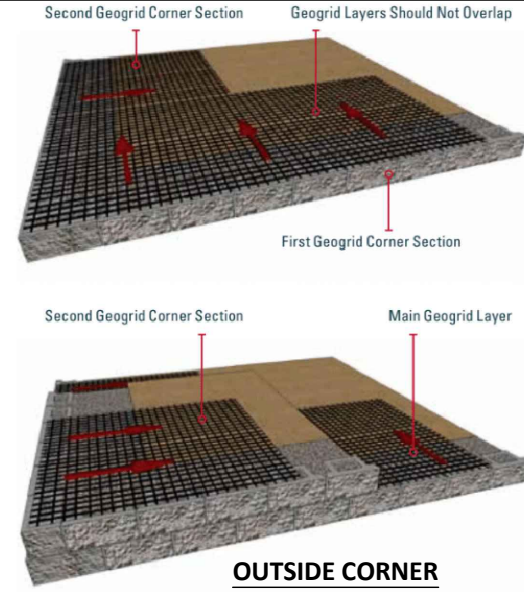
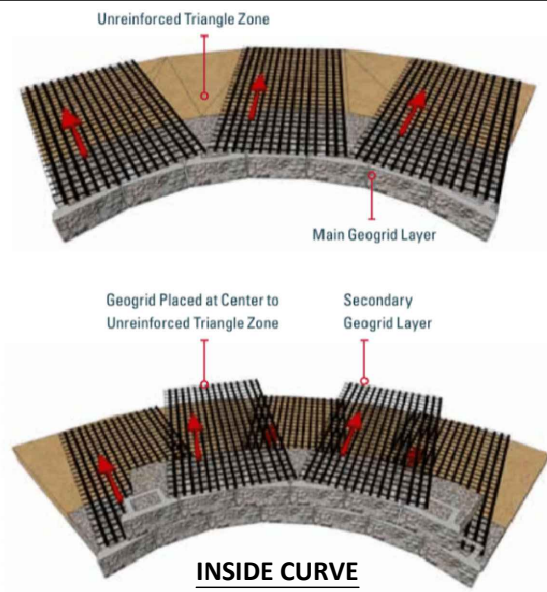
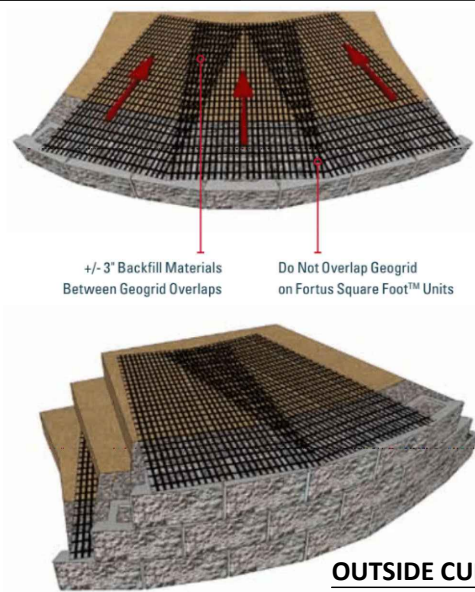

CORNER DETAIL
NOTE:

- PLACE SECOND UNIT AT RIGHT ANGLE AND CENTERED TO THE 1ST UNIT ON THE 2ND COURSE
- ENSURE SECOND COURSE UNITS ARE PLACED AT A 5/8" SETBACK TO THE LOWER INSIDE CORNER

CURVES AND CORNERS

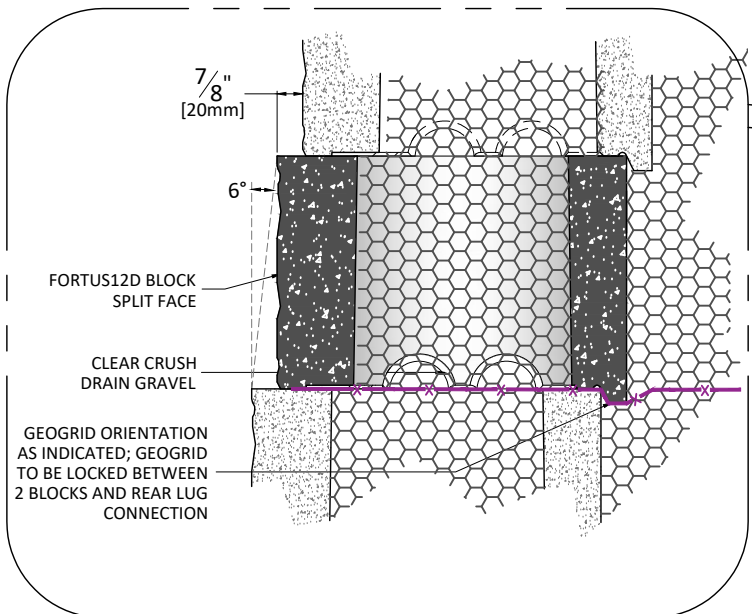

DETAIL

N.T.S.

- NOTE:**
- GEOGRID REINFORCEMENT PER DESIGN BY ENGINEER
 - CORRECT GEOGRID ORIENTATION, STRENGTH AND LENGTH IS CRUCIAL TO THE SUCCESS OF THE WALL PROJECT

WALL CROSS SECTION

SCALE: $\frac{3}{4}$ " = 1'-00"

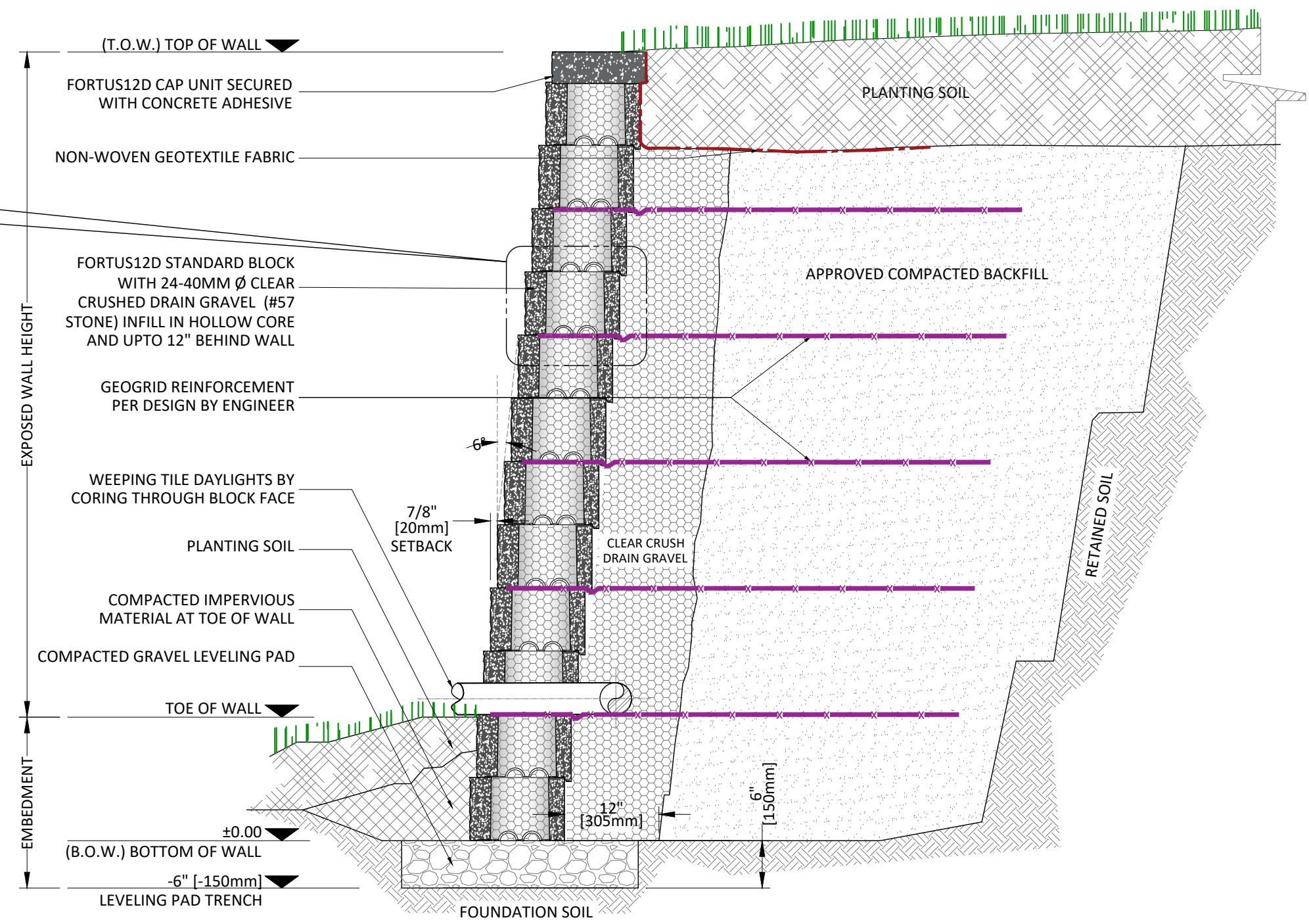

GENERAL NOTES:

These drawings are intended solely to act as an aid when designing a wall. This drawing should not be used for final design or construction.

Each site-specific wall should be certified and signed by a registered geotechnical engineer in the State or Province that it is being built.

The accuracy and use of the details in this document are the sole responsibility of the user.

Rev	DESCRIPTION	DATE
01	BLOCK CUTOOUT REVISED	07-26-2024

REMARKS:

PURPOSE OF ISSUE:

☐ INFORMATION
☐ REVIEW / APPROVAL
☐ PRODUCTION

SHEET CONTENT

GEOGRID WALL CROSS SECTION

COMMON APPLICATIONS

SHEET REFERENCE

202

1401-F12-GEN

DRAWING INFORMATION

SCALE : 3" : 1-0"
PAPER SIZE: 17" WD X 11" HT
PREPARED BY: RM

Fortus 12D
RETAINING WALLS

WWW.CORNERSTONEWALLSOLUTIONS.COM
1 (800) 939-9193

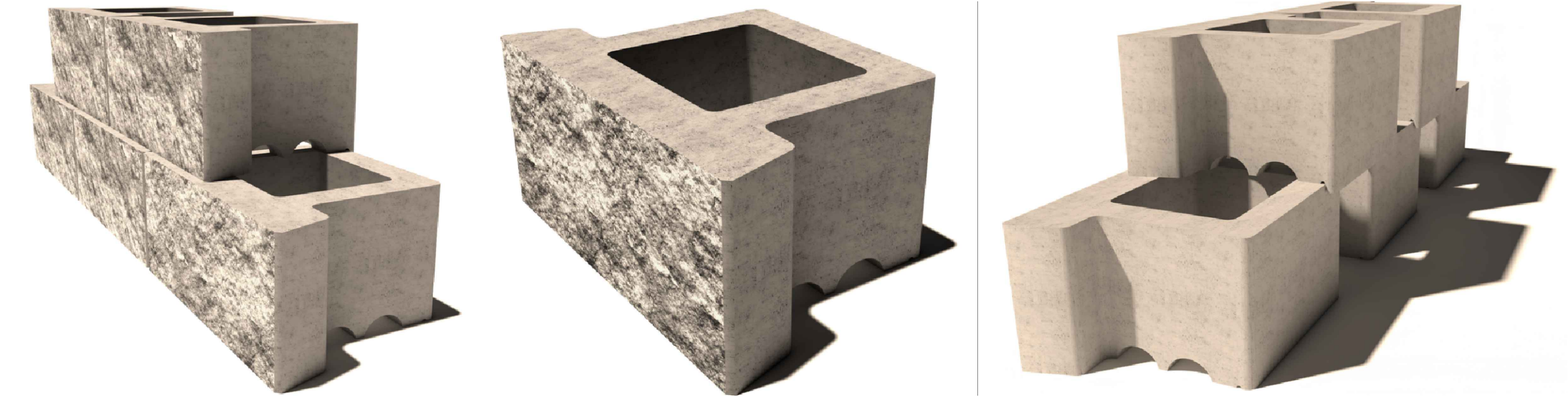

GENERAL NOTES:

These drawings are intended solely to act as an aid when designing a wall. This drawing should not be used for final design or construction.

Each site-specific wall should be certified and signed by a registered geotechnical engineer in the State or Province that it is being built.

The accuracy and use of the details in this document are the sole responsibility of the user.

01	BLOCK CUTOUT REVISED	07-26-2024
Rev	DESCRIPTION	DATE

REMARKS:

- PURPOSE OF ISSUE:**
- ☐ INFORMATION
 - ☐ REVIEW / APPROVAL
 - ☐ PRODUCTION

SHEET CONTENT

FORTUS_12D
PERSPECTIVE

SHEET REFERENCE

301

1401-F12-GEN

DRAWING INFORMATION

SCALE : 3" : 1'-0"

PAPER SIZE: 17" WD X 11" HT

PREPARED BY: RM

